

# FLUSHFIX® on demand

## Your data :

Company : \_\_\_\_\_ Contact person name : \_\_\_\_\_  
Address : \_\_\_\_\_ Postal Code : \_\_\_\_\_ City : \_\_\_\_\_  
\_\_\_\_\_ Country : \_\_\_\_\_  
\_\_\_\_\_ Phone : \_\_\_\_\_ Fax : \_\_\_\_\_  
e-mail : \_\_\_\_\_ Web Site : \_\_\_\_\_  
Industry : \_\_\_\_\_

## 1 FLUSHFIX® MATERIAL

STEEL  STAINLESS STEEL  316L STAINLESS STEEL  OTHER : \_\_\_\_\_

## 2 SKIRT

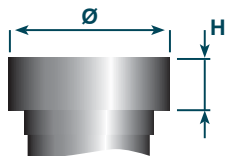

H  Standard  
 Special : \_\_\_\_\_ mm  
Ø  Standard  
 Special : \_\_\_\_\_ mm

## 3 THREADS

Ø M \_\_\_\_\_  standard pitch  
 Ø UNC \_\_\_\_\_  fine pitch  
 Ø UNF \_\_\_\_\_  other : \_\_\_\_\_

## 4 WITHSTAND REQUIREMENTS

Standard  Special : \_\_\_\_\_ Tensile force : \_\_\_\_\_ daN  
Direct torque force : \_\_\_\_\_ Nm  
Indirect torque force : \_\_\_\_\_ Nm  
Other : \_\_\_\_\_

## 5 FINISH

Corrosion resistance required : \_\_\_\_\_ Standard : \_\_\_\_\_  
White rust : \_\_\_\_\_ h  
Red rust : \_\_\_\_\_ h

Friction coefficient required : \_\_\_\_\_  
Finish required : \_\_\_\_\_

## 6 APPLICATION

### CHARACTERISTICS OF THE WORKPIECE RECEIVING FLUSHFIX®

Minimum thickness : \_\_\_\_\_ mm / Maximum : \_\_\_\_\_ mm Material : \_\_\_\_\_  
Final product : \_\_\_\_\_  
Internal protrusion allowed: \_\_\_\_\_ mm  
Other requirements : \_\_\_\_\_

## 7 VOLUMES

Batch quantity required : \_\_\_\_\_ Forecast :  
Yearly quantity : \_\_\_\_\_ 2<sup>nd</sup> year : \_\_\_\_\_ parts  
Application lifetime : \_\_\_\_\_ 3<sup>rd</sup> year : \_\_\_\_\_ parts